

Oil-injected Air-end V100



PROFILE: Designed to offer maximum performance even in extreme conditions, efficiency and duration. It guarantees high airflow with a minimum energy consumption.

BEARINGS: Radial and thrust bearings are created to be lasting. Only first-quality bearings are used.

FRONT SEALINGS: No oil loss thanks to excellent materials and suitable dimensions.

User-friendliness for a simple and fast replacement.

APPLICATION: For belt and direct connections.

ASSEMBLY: Body parts are joined with O-rings. In this way, the maintenance is easy, fast and reliable.

ROTOR ADJUSTMENT: Threaded rings are used to adjust rotors for a very fast, reliable and repeatable maintenance.

TECHNICAL DATA

Size		V100
Drive		Direct by coupling or belt
Outside male diameter:	mm	111,3
	inch	4,4
Outside female diameter:	mm	88
	inch	3,46
L/D:		1,55
Air Capacity (ISO 1217 ANNEX B 2009)	m³/min	1,1 - 4
	cfm	30,3 -141,3
Max Working Pressure	bar g	10
	psi g	145,4
Min Working Pressure	bar g	5
	psi g	73
Oil injected Quantity	L/min	50 - 63
	gal/min (US)	13,2 - 16,6
Max Input Power	kW	28
	hp	37,5
Max main rotor speed	rpm	4500
Max outlet air/oil Temperature	°C	105
	°F	221
Weight	kg	45
	lb	99

Air flow rate related to suction condition according to ISO 1217 Annex B 2009: relative humidity=60%; suction press. (abs)=1 bar; suction temp.=20°C; disch. temp.=80°C

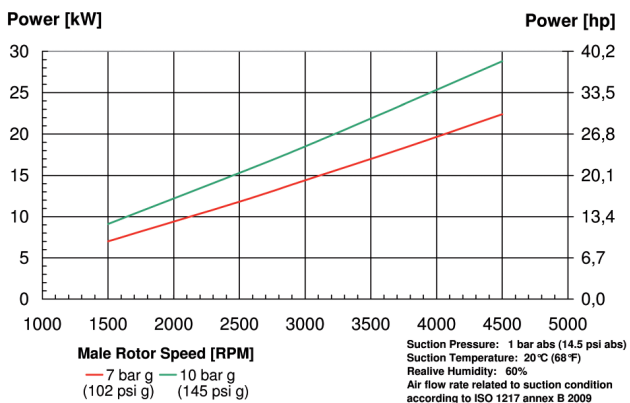
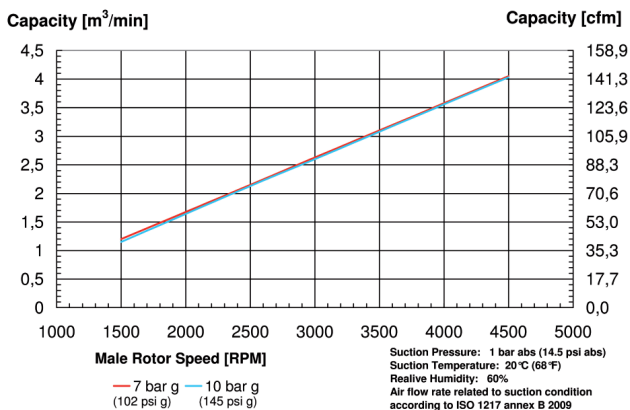

Drawing dimensions in mm.
Inch dimensions available
on VMC website.

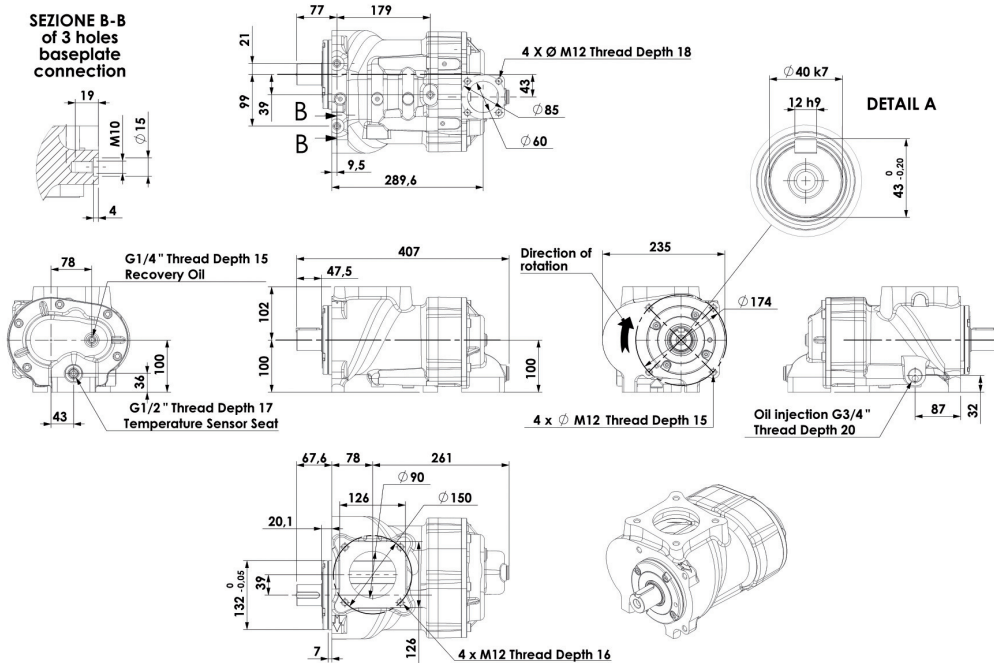

Integrated System V100/VTDM

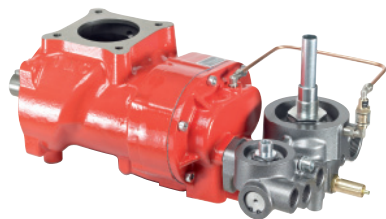

This system integrates the properly designed combination block to the AIR-END series. It offers a unique, compact system user-friendly and fast to be assembled. The air outlet and oil inlet have been designed for simple and fast connections. Pipe length has been designed to be short for a better performance and reduce pressure drop. The position of inside components has been engineered for easy, fast and safe maintenance operations. The system offers high interchangeability.

TECHNICAL DATA

Size		V100/VTDM
		For performances data see V100 technical data
Oil Inlet/Outlet		Rp 3/4"
Air outlet (From Air-end)	mm	Ø60
	inch	Ø 2,36
Air Inlet (From Tank)		Rp 1-1/4"
Air outlet (From MPV)		Rp 1-1/4"
Oil nipples Size		3/4"-16UNF, G 3/4" or 1"-12 UNF
Air nipples Size		M32x1,5 or M39x1,5
Thermostat Temp. Setting	°C	Three thermostat available: 55-70; 71-85 or 83-95
	°F	Three thermostat available:: 131-158; 159,8-185 or 181,4-203
Materials		Unit is made in anodized aluminium alloy, steel and cast iron. Inside parts in aluminium alloy, steel, brass and viton sealing.
A	mm	110
	inch	4,33
A1	mm	243
	inch	9,56
B	mm	215
	inch	8,46
C1	mm	300
	inch	11,81
Y	mm	532
	inch	20,94
Weight	kg	52
	lb	114,5

